

Brass Twin Ferrule Compression Fittings (Category 29)



**#1B
Ferrule Set**

Code	Tube
29-B001-02	1/8
29-B001-03	3/16
29-B001-04	1/4
29-B001-05	5/16
29-B001-06	3/8
29-B001-08	1/2
29-B001-10	5/8
29-B001-12	3/4
29-B001-16	1"
29-B001-20	1.1/4
29-B001-24	1.1/2
29-B301-06	6mm



**#2B
Tube Nut**

Code	Tube	Thread
29-B002-02	1/8	5/16x20
29-B002-03	3/16	3/8x20
29-B002-04	1/4	7/16x20
29-B002-05	5/16	1/2x20
29-B002-06	3/8	9/16x20
29-B002-08	1/2	3/4x20
29-B002-10	5/8	7/8x20
29-B002-12	3/4	1"x20
29-B002-16	1"	1.5/16x20
29-B002-20	1.1/4	1.5/8x20
29-B002-24	1.1/2	1.15/16x20
29-B302-06	6mm	7/16x20



**#3B
Male
Connector**

Code	Tube	Male
29-B003-0202	1/8	1/8 BSPT
29-B003-0204	1/8	1/4 BSPT
29-B003-0302	3/16	1/8 BSPT
29-B003-0304	3/16	1/4 BSPT
29-B003-0402	1/4	1/8 BSPT
29-B003-0404	1/4	1/4 BSPT
29-B003-0406	1/4	3/8 BSPT
29-B003-0408	1/4	1/2 BSPT
29-B003-0502	5/16	1/8 BSPT
29-B003-0504	5/16	1/4 BSPT
29-B003-0506	5/16	3/8 BSPT
29-B003-0602	3/8	1/8 BSPT
29-B003-0604	3/8	1/4 BSPT
29-B003-0606	3/8	3/8 BSPT
Continued next Column		



**#3B
Male
Connector**

Code	Tube	Male
From Previous Column		
29-B003-0608	3/8	1/2 BSPT
29-B003-0612	3/8	3/4 BSPT
29-B003-0804	1/2	1/4 BSPT
29-B003-0806	1/2	3/8 BSPT
29-B003-0808	1/2	1/2 BSPT
29-B003-0812	1/2	3/4 BSPT
29-B003-1006	5/8	3/8 BSPT
29-B003-1008	5/8	1/2 BSPT
29-B003-1012	5/8	3/4 BSPT
29-B003-1208	3/4	1/2 BSPT
29-B003-1212	3/4	3/4 BSPT
29-B003-1216	3/4	1" BSPT
29-B003-1612	1"	3/4 BSPT
29-B003-1616	1"	1" BSPT
29-B003-2016	1.1/4	1" BSPT
29-B003-2020	1.1/4	1.1/4 BSPT
29-B003-2420	1.1/2	1.1/4 BSPT
29-B003-2424	1.1/2	1.1/2 BSPT
29-B103-0602	3/8	1/8 BSPP
29-B203-0202	1/8	1/8 NPT
29-B203-0204	1/8	1/4 NPT
29-B203-0302	3/16	1/8 NPT
29-B203-0304	3/16	1/4 NPT
29-B203-0402	1/4	1/8 NPT
29-B203-0404	1/4	1/4 NPT
29-B203-0406	1/4	3/8 NPT
29-B203-0408	1/4	1/2 NPT
29-B203-0502	5/16	1/8 NPT
29-B203-0504	5/16	1/4 NPT
29-B203-0506	5/16	3/8 NPT
29-B203-0602	3/8	1/8 NPT
29-B203-0604	3/8	1/4 NPT
29-B203-0606	3/8	3/8 NPT
29-B203-0608	3/8	1/2 NPT
29-B203-0804	1/2	1/4 NPT
29-B203-0806	1/2	3/8 NPT
29-B203-0808	1/2	1/2 NPT
29-B203-0812	1/2	3/4 NPT
29-B203-0816	1/2	1" NPT
29-B203-1006	5/8	3/8 NPT
29-B203-1008	5/8	1/2 NPT
29-B203-1012	5/8	3/4 NPT
29-B203-1208	3/4	1/2 NPT
29-B203-1212	3/4	3/4 NPT
29-B203-1216	3/4	1" NPT
29-B203-1612	1"	3/4 NPT
29-B203-1616	1"	1" NPT
29-B303-0604	6mm	1/4 BSPT
29-B303-0608	6mm	1/2 BSPT



**#4B
Tube
Union**

Code	Tube
29-B004-02	1/8
29-B004-03	3/16
29-B004-04	1/4
29-B004-05	5/16
29-B004-06	3/8
29-B004-08	1/2
29-B004-10	5/8
29-B004-12	3/4
29-B004-16	1"
29-B004-20	1.1/4
29-B004-24	1.1/2



**#4RB
Reducing
Tube Union**

Code	Tube	Tube
29-B004R-0402	1/4	1/8
29-B004R-0403	1/4	3/16
29-B004R-0504	5/16	1/4
29-B004R-0604	3/8	1/4
29-B004R-0605	3/8	5/16
29-B004R-0804	1/2	1/4
29-B004R-0806	1/2	3/8
29-B004R-1008	5/8	1/2
29-B004R-1208	3/4	1/2
29-B004R-1210	3/4	5/8
29-B004R-1612	1"	3/4



**#5B
Male
Elbow**

Code	Tube	Male
29-B005-0202	1/8	1/8 BSPT
29-B005-0204	1/8	1/4 BSPT
29-B005-0302	3/16	1/8 BSPT
29-B005-0402	1/4	1/8 BSPT
29-B005-0404	1/4	1/4 BSPT
29-B005-0406	1/4	3/8 BSPT
29-B005-0502	5/16	1/8 BSPT
29-B005-0504	5/16	1/4 BSPT
29-B005-0506	5/16	3/8 BSPT
29-B005-0602	3/8	1/8 BSPT
29-B005-0604	3/8	1/4 BSPT
29-B005-0606	3/8	3/8 BSPT
29-B005-0608	3/8	1/2 BSPT
Continued Next Page		

Brass Twin Ferrule Compression Fittings (Category 29)



**#5B
Male
Elbow**

Code	Tube	Male
From Previous Page		
29-B005-0804	1/2	1/4 BSPT
29-B005-0806	1/2	3/8 BSPT
29-B005-0808	1/2	1/2 BSPT
29-B005-0812	1/2	3/4 BSPT
29-B005-1006	5/8	3/8 BSPT
29-B005-1008	5/8	1/2 BSPT
29-B005-1208	3/4	1/2 BSPT
29-B005-1212	3/4	3/4 BSPT
29-B005-1612	1"	3/4 BSPT
29-B005-1616	1"	1" BSPT
29-B005-2016	1.1/4	1" BSPT
29-B005-2424	1.1/2	1.1/2 BSPT
29-B205-0202	1/8	1/8 NPT
29-B205-0204	1/8	1/4 NPT
29-B205-0302	3/16	1/8 NPT
29-B205-0402	1/4	1/8 NPT
29-B205-0404	1/4	1/4 NPT
29-B205-0406	1/4	3/8 NPT
29-B205-0408	1/4	1/2 NPT
29-B205-0502	5/16	1/8 NPT
29-B205-0504	5/16	1/4 NPT
29-B205-0602	3/8	1/8 NPT
29-B205-0604	3/8	1/4 NPT
29-B205-0606	3/8	3/8 NPT
29-B205-0608	3/8	1/2 NPT
29-B205-0804	1/2	1/4 NPT
29-B205-0806	1/2	3/8 NPT
29-B205-0808	1/2	1/2 NPT
29-B205-0812	1/2	3/4 NPT
29-B205-1008	5/8	1/2 NPT
29-B205-1208	3/4	1/2 NPT
29-B205-1212	3/4	3/4 NPT
29-B205-1612	1"	3/4 NPT
29-B205-1616	1"	1" NPT



**#11B
Elbow Tube
Union**

Code	Tube
29-B011-02	1/8
29-B011-03	3/16
29-B011-04	1/4
29-B011-05	5/16
29-B011-06	3/8
29-B011-08	1/2
29-B011-10	5/8
29-B011-12	3/4
29-B011-16	1"



**#10B
Female
Connector**

Code	Tube	Female
29-B010-0202	1/8	1/8 BSPT
29-B010-0302	3/16	1/8 BSPT
29-B010-0402	1/4	1/8 BSPT
29-B010-0404	1/4	1/4 BSPT
29-B010-0406	1/4	3/8 BSPT
29-B010-0408	1/4	1/2 BSPT
29-B010-0502	5/16	1/8 BSPT
29-B010-0504	5/16	1/4 BSPT
29-B010-0602	3/8	1/8 BSPT
29-B010-0604	3/8	1/4 BSPT
29-B010-0606	3/8	3/8 BSPT
29-B010-0608	3/8	1/2 BSPT
29-B010-0804	1/2	1/4 BSPT
29-B010-0806	1/2	3/8 BSPT
29-B010-0808	1/2	1/2 BSPT
29-B010-0812	1/2	3/4 BSPT
29-B010-1008	5/8	1/2 BSPT
29-B010-1208	3/4	1/2 BSPT
29-B010-1212	3/4	3/4 BSPT
29-B010-1616	1"	1" BSPT
29-B010-2016	1.1/4	1" BSPT
29-B010-2020	1.1/4	1.1/4 BSPT
29-B210-0202	1/8	1/8 NPT
29-B210-0402	1/4	1/8 NPT
29-B210-0404	1/4	1/4 NPT
29-B210-0406	1/4	3/8 NPT
29-B210-0408	1/4	1/2 NPT
29-B210-0502	5/16	1/8 NPT
29-B210-0604	3/8	1/4 NPT
29-B210-0606	3/8	3/8 NPT
29-B210-0608	3/8	1/2 NPT
29-B210-0804	1/2	1/4 NPT
29-B210-0806	1/2	3/8 NPT
29-B210-0808	1/2	1/2 NPT
29-B210-0812	1/2	3/4 NPT
29-B210-1208	3/4	1/2 NPT
29-B210-1212	3/4	3/4 NPT
29-B210-1612	1"	3/4 NPT
29-B210-1616	1"	1" NPT



**#12B
Male Branch
Tee**

Code	Tube	Male
29-B012-0202	1/8	1/8 BSPT
29-B012-0302	3/16	1/8 BSPT
29-B012-0402	1/4	1/8 BSPT
29-B012-0404	1/4	1/4 BSPT
29-B012-0502	5/16	1/8 BSPT
29-B012-0504	5/16	1/4 BSPT
29-B012-0604	3/8	1/4 BSPT
29-B012-0606	3/8	3/8 BSPT
29-B012-0804	1/2	1/4 BSPT
29-B012-0806	1/2	3/8 BSPT
29-B012-0808	1/2	1/2 BSPT
29-B012-1616	1"	1" BSPT
29-B212-0202	1/8	1/8 NPT
29-B212-0402	1/4	1/8 NPT
29-B212-0404	1/4	1/4 NPT
29-B212-0604	3/8	1/4 NPT
29-B212-0606	3/8	3/8 NPT
29-B212-0806	1/2	3/8 NPT



**#12FB
Female
Branch Tee**

Code	Tube	Female
29-B012F-0202	1/8	1/8 BSPT
29-B012F-0402	1/4	1/8 BSPT
29-B012F-0404	1/4	1/4 BSPT
29-B012F-0604	3/8	1/4 BSPT
29-B012F-0806	1/2	3/8 BSPT
29-B012F-0808	1/2	1/2 BSPT
29-B012F-1008	5/8	1/2 BSPT
29-B012F-1208	3/4	1/2 BSPT
29-B012F-1212	3/4	3/4 BSPT
29-B012F-1612	1"	3/4 BSPT
29-B012F-1616	1"	1" BSPT
29-B012F-2016	1.1/4	1" BSPT
29-B212F-0402	1/4	1/8 NPT
29-B212F-0404	1/4	1/4 NPT
29-B212F-0604	3/8	1/4 NPT
29-B212F-0806	1/2	3/8 NPT
29-B212F-1008	5/8	1/2 NPT
29-B212F-1212	3/4	3/4 NPT



Copper Tube also available in annealed coils and hard drawn lengths.

Refer Category 45

Brass Twin Ferrule Compression Fittings (Category 29)



**#13B
Male Run Tee**

Code	Tube	Male
29-B013-0402	1/4	1/8 BSPT
29-B013-0404	1/4	1/4 BSPT
29-B013-0604	3/8	1/4 BSPT
29-B013-0606	3/8	3/8 BSPT
29-B013-0806	1/2	3/8 BSPT
29-B013-0808	1/2	1/2 BSPT
29-B013-1212	3/4	3/4 BSPT
29-B213-0202	1/8	1/8 NPT
29-B213-0402	1/4	1/8 NPT
29-B213-0404	1/4	1/4 NPT
29-B213-0604	3/8	1/4 NPT
29-B213-0606	3/8	3/8 NPT
29-B213-0806	1/2	3/8 NPT
29-B213-0808	1/2	1/2 NPT



**#13FB
Female Run Tee**

Code	Tube	Female
29-B013F-0402	1/4	1/8 BSPT
29-B013F-0404	1/4	1/4 BSPT
29-B013F-0604	3/8	1/4 BSPT
29-B013F-0806	1/2	3/8 BSPT
29-B013F-0808	1/2	1/2 BSPT
29-B013F-1612	1"	3/4 BSPT
29-B213F-0402	1/4	1/8 NPT
29-B213F-0404	1/4	1/4 NPT
29-B213F-0604	3/8	1/4 NPT
29-B213F-0806	1/2	3/8 NPT
29-B213F-0808	1/2	1/2 NPT



**#14B
Tee Tube Union**

Code	Tube
29-B014-02	1/8
29-B014-03	3/16
29-B014-04	1/4
29-B014-05	5/16
29-B014-06	3/8
29-B014-08	1/2
29-B014-10	5/8
29-B014-12	3/4
29-B014-16	1"



**#15B
Female Elbow**

Code	Tube	Female
29-B015-0202	1/8	1/8 BSPT
29-B015-0402	1/4	1/8 BSPT
29-B015-0404	1/4	1/4 BSPT
29-B015-0408	1/4	1/2 BSPT
29-B015-0504	5/16	1/4 BSPT
29-B015-0604	3/8	1/4 BSPT
29-B015-0606	3/8	3/8 BSPT
29-B015-0804	1/2	1/4 BSPT
29-B015-0806	1/2	3/8 BSPT
29-B015-0808	1/2	1/2 BSPT
29-B015-1006	5/8	3/8 BSPT
29-B015-1008	5/8	1/2 BSPT
29-B015-1208	3/4	1/2 BSPT
29-B015-1212	3/4	3/4 BSPT
29-B015-1612	1"	3/4 BSPT
29-B015-1616	1"	1" BSPT
29-B215-0202	1/8	1/8 NPT
29-B215-0302	3/16	1/8 NPT
29-B215-0402	1/4	1/8 NPT
29-B215-0404	1/4	1/4 NPT
29-B215-0406	1/4	3/8 NPT
29-B215-0408	1/4	1/2 NPT
29-B215-0502	5/16	1/8 NPT
29-B215-0604	3/8	1/4 NPT
29-B215-0606	3/8	3/8 NPT
29-B215-0608	3/8	1/2 NPT
29-B215-0804	1/2	1/4 NPT
29-B215-0806	1/2	3/8 NPT
29-B215-0808	1/2	1/2 NPT
29-B215-1008	5/8	1/2 NPT
29-B215-1212	3/4	3/4 NPT
29-B215-1612	1"	3/4 NPT

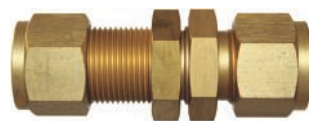

**#31B
Bulkhead Union**

Code	Tube
29-B031-02	1/8
29-B031-03	3/16
29-B031-04	1/4
29-B031-05	5/16
29-B031-06	3/8
29-B031-08	1/2
29-B031-10	5/8
29-B031-12	3/4
29-B031-16	1"
29-B031-20	1.1/4

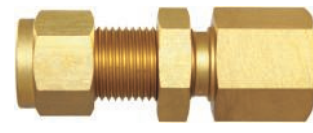

**#31FB
Female Bulkhead**

Code	Tube	Female
29-B031F-0302	3/16	1/8 BSPT
29-B031F-0402	1/4	1/8 BSPT
29-B031F-0404	1/4	1/4 BSPT
29-B031F-0604	3/8	1/4 BSPT
29-B031F-0606	3/8	3/8 BSPT
29-B031F-0806	1/2	3/8 BSPT
29-B031F-0808	1/2	1/2 BSPT
29-B231F-0202	1/8	1/8 NPT
29-B231F-0404	1/4	1/4 NPT
29-B231F-0604	3/8	1/4 NPT
29-B231F-0606	3/8	3/8 NPT
29-B231F-0806	1/2	3/8 NPT
29-B231F-0808	1/2	1/2 NPT



**#31MB
Male Bulkhead**

Code	Tube	Male
29-B031M-0402	1/4	1/8 BSPT
29-B031M-0404	1/4	1/4 BSPT
29-B031M-0604	3/8	1/4 BSPT
29-B031M-0606	3/8	3/8 BSPT
29-B031M-0806	1/2	3/8 BSPT
29-B031M-0808	1/2	1/2 BSPT
29-B231M-0402	1/4	1/8 NPT
29-B231M-0404	1/4	1/4 NPT
29-B231M-0604	3/8	1/4 NPT
29-B231M-0606	3/8	3/8 NPT
29-B231M-0806	1/2	3/8 NPT
29-B231M-0808	1/2	1/2 NPT



**#44B
Port Connector**

Code	Tube
29-B044-04	1/4
29-B044-06	3/8
29-B044-08	1/2
29-B044-12	3/4



**#44RB
Reducing Port Connector**

Code	Tube	Stem
29-B044R-0604	3/8	1/4
29-B044R-0806	1/2	3/8
29-B044R-1208	3/4	1/2

Brass Twin Ferrule Compression Fittings (Category 29)



#56B
Tube Plug

Code	Tube
29-B056-02	1/8
29-B056-03	3/16
29-B056-04	1/4
29-B056-06	3/8
29-B056-08	1/2
29-B056-12	3/4
29-B056-16	1"



#65B
Tube Cap

Code	Tube
29-B065-02	1/8
29-B065-03	3/16
29-B065-04	1/4
29-B065-06	3/8
29-B065-08	1/2
29-B065-12	3/4
29-B065-16	1"



#72MB
Male Tube
Adaptor

Code	Stem	Male
29-B072M-0302	3/16	1/8 BSPT
29-B072M-0402	1/4	1/8 BSPT
29-B072M-0404	1/4	1/4 BSPT
29-B072M-0406	1/4	3/8 BSPT
29-B072M-0408	1/4	1/2 BSPT
29-B072M-0604	3/8	1/4 BSPT
29-B072M-0606	3/8	3/8 BSPT
29-B072M-0608	3/8	1/2 BSPT
29-B072M-0804	1/2	1/4 BSPT
29-B072M-0806	1/2	3/8 BSPT
29-B072M-0808	1/2	1/2 BSPT
29-B072M-1212	3/4	3/4 BSPT
29-B272M-0204	1/8	1/4 NPT
29-B272M-0402	1/4	1/8 NPT
29-B272M-0404	1/4	1/4 NPT
29-B272M-0406	1/4	3/8 NPT
29-B272M-0408	1/4	1/2 NPT
29-B272M-0604	3/8	1/4 NPT
29-B272M-0606	3/8	3/8 NPT
29-B272M-0608	3/8	1/2 NPT
29-B272M-0804	1/2	1/4 NPT
29-B272M-0806	1/2	3/8 NPT
29-B272M-0808	1/2	1/2 NPT



#68B
Union Cross

Code	Tube
29-B068-02	1/8
29-B068-04	1/4
29-B068-05	5/16
29-B068-06	3/8
29-B068-08	1/2



#72FB
Female Tube
Adaptor

Code	Stem	Female
29-B072F-0402	1/4	1/8 BSPT
29-B072F-0404	1/4	1/4 BSPT
29-B072F-0406	1/4	3/8 BSPT
29-B072F-0604	3/8	1/4 BSPT
29-B072F-0606	3/8	3/8 BSPT
29-B072F-0608	3/8	1/2 BSPT
29-B072F-0806	1/2	3/8 BSPT
29-B072F-0808	1/2	1/2 BSPT
29-B072F-1612	1"	3/4 BSPT
29-B072F-1616	1"	1" BSPT
29-B272F-0204	1/8	1/4 NPT
29-B272F-0402	1/4	1/8 NPT
29-B272F-0404	1/4	1/4 NPT
29-B272F-0406	1/4	3/8 NPT
29-B272F-0604	3/8	1/4 NPT
29-B272F-0606	3/8	3/8 NPT
29-B272F-0608	3/8	1/2 NPT
29-B272F-0806	1/2	3/8 NPT
29-B272F-0808	1/2	1/2 NPT
29-B272F-1008	5/8	1/2 NPT



#72AB
Reducing
Tube Adaptor

Code	Stem	Tube
29-B072A-0204	1/8	1/4
29-B072A-0402	1/4	1/8
29-B072A-0406	1/4	3/8
29-B072A-0408	1/4	1/2
29-B072A-0504	5/16	1/4
29-B072A-0604	3/8	1/4
29-B072A-0608	3/8	1/2
29-B072A-0804	1/2	1/4
29-B072A-0806	1/2	3/8
29-B072A-1208	3/4	1/2

Note : The pressure rating of twin ferrule fittings exceeds that of the tube, provided the tube is seamless and of a softer material than the fitting.

They can be reassembled multiple times by tightening slightly from the original tight position. Components must be kept free of contaminants while disassembled.

Assembly instruction for Twin Ferrule Fittings up to 1"

1. Cut the tube squarely and free from burrs.
2. Insert the tube into the fitting, ensuring it is completely in contact with the shoulder of the fitting, then finger tighten the nut.
3. Mark the starting position and tighten 1.1/4 turns with a spanner from finger tight.

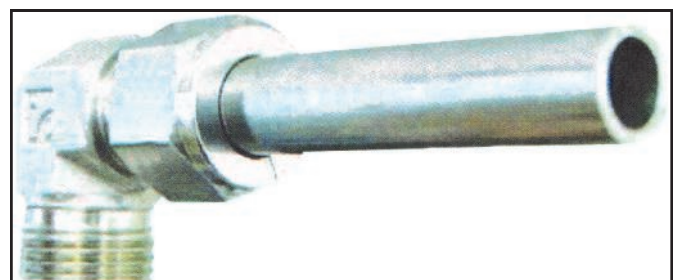
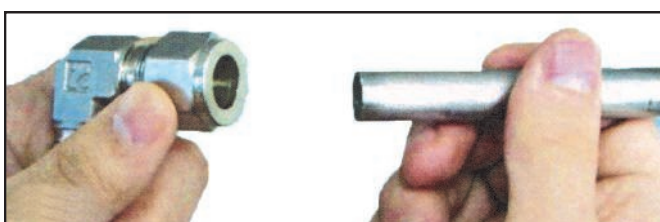

Stainless Steel Twin Ferrule Compression Fittings (Category 29)



**#1SS
Ferrule Set**

Code	Tube
29-S001-01	1/16
29-S001-02	1/8
29-S001-03	3/16
29-S001-04	1/4
29-S001-05	5/16
29-S001-06	3/8
29-S001-08	1/2
29-S001-10	5/8
29-S001-12	3/4
29-S001-16	1"
29-S301-04	4mm
29-S301-06	6mm
29-S301-10	10mm
29-S301-12	12mm
29-S301-15	15mm



**#2SS
Tube Nut**

Code	Tube	Thread
29-S002-01	1/16	10-32
29-S002-02	1/8	5/16x20
29-S002-03	3/16	3/8x20
29-S002-04	1/4	7/16x20
29-S002-05	5/16	1/2x20
29-S002-06	3/8	9/16x20
29-S002-08	1/2	3/4x20
29-S002-10	5/8	7/8x20
29-S002-12	3/4	1"x20
29-S002-16	1"	1.5/16x20
29-S302-04	4mm	3/8x20
29-S302-06	6mm	7/16x20
29-S302-08	8mm	1/2x20
29-S302-12	12mm	3/4x20
29-S302-15	15mm	7/8x20



**#3SS
JIC Male
Connector**

Code	Tube	Male
29-S603-0404	1/4	7/16 JIC
29-S603-0505	5/16	1/2 JIC
29-S603-0604	3/8	7/16 JIC
29-S603-0606	3/8	9/16 JIC
29-S603-0808	1/2	3/4 JIC



**#3SS
Male
Connector**

Code	Tube	Male
29-S003-0102	1/16	1/8 BSPT
29-S003-0202	1/8	1/8 BSPT
29-S003-0204	1/8	1/4 BSPT
29-S003-0208	1/8	1/2 BSPT
29-S003-0302	3/16	1/8 BSPT
29-S003-0304	3/16	1/4 BSPT
29-S003-0402	1/4	1/8 BSPT
29-S003-0404	1/4	1/4 BSPT
29-S003-0406	1/4	3/8 BSPT
29-S003-0408	1/4	1/2 BSPT
29-S003-0412	1/4	3/4 BSPT
29-S003-0502	5/16	1/8 BSPT
29-S003-0504	5/16	1/4 BSPT
29-S003-0506	5/16	3/8 BSPT
29-S003-0508	5/16	1/2 BSPT
29-S003-0602	3/8	1/8 BSPT
29-S003-0604	3/8	1/4 BSPT
29-S003-0606	3/8	3/8 BSPT
29-S003-0608	3/8	1/2 BSPT
29-S003-0612	3/8	3/4 BSPT
29-S003-0802	1/2	1/8 BSPT
29-S003-0804	1/2	1/4 BSPT
29-S003-0806	1/2	3/8 BSPT
29-S003-0808	1/2	1/2 BSPT
29-S003-0812	1/2	3/4 BSPT
29-S003-0816	1/2	1" BSPT
29-S003-1006	5/8	3/8 BSPT
29-S003-1008	5/8	1/2 BSPT
29-S003-1012	5/8	3/4 BSPT
29-S003-1206	3/4	3/8 BSPT
29-S003-1208	3/4	1/2 BSPT
29-S003-1212	3/4	3/4 BSPT
29-S003-1216	3/4	1" BSPT
29-S003-1608	1"	1/2 BSPT
29-S003-1612	1"	3/4 BSPT
29-S003-1616	1"	1" BSPT
29-S103-0402	1/4	1/8 BSPP
29-S103-0404	1/4	1/4 BSPP
29-S103-0406	1/4	3/8 BSPP
29-S103-0808	1/2	1/2 BSPP
29-S103-2016	1.1/4	1" BSPP
29-S203-0101	1/16	1/16 NPT
29-S203-0202	1/8	1/8 NPT
29-S203-0204	1/8	1/4 NPT
29-S203-0302	3/16	1/8 NPT
29-S203-0304	3/16	1/4 NPT
29-S203-0401	1/4	1/16 NPT
29-S203-0402	1/4	1/8 NPT

Continued next Column



**#3SS
Male
Connector**

Code	Tube	Male
From Previous Column		
29-S203-0404	1/4	1/4 NPT
29-S203-0406	1/4	3/8 NPT
29-S203-0408	1/4	1/2 NPT
29-S203-0412	1/4	3/4 NPT
29-S203-0502	5/16	1/8 NPT
29-S203-0504	5/16	1/4 NPT
29-S203-0602	3/8	1/8 NPT
29-S203-0604	3/8	1/4 NPT
29-S203-0606	3/8	3/8 NPT
29-S203-0608	3/8	1/2 NPT
29-S203-0612	3/8	3/4 NPT
29-S203-0616	3/8	1" NPT
29-S203-0802	1/2	1/8 NPT
29-S203-0804	1/2	1/4 NPT
29-S203-0806	1/2	3/8 NPT
29-S203-0808	1/2	1/2 NPT
29-S203-0812	1/2	3/4 NPT
29-S203-0816	1/2	1" NPT
29-S203-1006	5/8	3/8 NPT
29-S203-1008	5/8	1/2 NPT
29-S203-1012	5/8	3/4 NPT
29-S203-1208	3/4	1/2 NPT
29-S203-1212	3/4	3/4 NPT
29-S203-1216	3/4	1" NPT
29-S203-1608	1"	1/2 NPT
29-S203-1612	1"	3/4 NPT
29-S203-1616	1"	1" NPT
29-S203-2016	1.1/4	1" NPT
29-S303-0402	4mm	1/8 BSPT
29-S303-0602	6mm	1/8 BSPT
29-S303-0604	6mm	1/4 BSPT
29-S303-0606	6mm	3/8 BSPT
29-S303-0608	6mm	1/2 BSPT
29-S303-1004	10mm	1/4 BSPT
29-S303-1006	10mm	3/8 BSPT
29-S303-1008	10mm	1/2 BSPT
29-S303-1204	12mm	1/4 BSPT
29-S303-1206	12mm	3/8 BSPT
29-S303-1208	12mm	1/2 BSPT



**#3SS
O-Seal Male
Connector**

Code	Tube	Male
29-S703-0202	1/8	5/16 SAE
29-S703-0404	1/4	7/16 SAE

Stainless Steel Twin Ferrule Compression Fittings (Category 29)



#3SS
UNO Male
Connector

Code	Tube	Male
29-S803-0404	1/4	7/16 UNO
29-S803-0806	1/2	9/16 UNO
29-S803-1208	3/4	3/4 UNO



#3TSS
Thermocouple
Male Conn

Code	Tube	Male
29-S003T-0608	3/8	1/2 BSPT
29-S003T-0808	1/2	1/2 BSPT
29-S203T-0604	3/8	1/4 NPT
29-S203T-0808	1/2	1/2 NPT



#4SS
Tube
Union

Code	Tube
29-S004-01	1/16
29-S004-02	1/8
29-S004-03	3/16
29-S004-04	1/4
29-S004-05	5/16
29-S004-06	3/8
29-S004-08	1/2
29-S004-10	5/8
29-S004-12	3/4
29-S004-16	1"
29-S004-32	2"
29-S304-06	6mm
29-S304-08	8mm
29-S304-10	10mm
29-S304-12	12mm
29-S304-15	15mm



#5SS
UNO Positionable
Male Elbow

Code	Tube	Male
29-S805-0808	1/2	3/4 UNO



#4RSS
Reducing
Tube Union

Code	Tube	Tube
29-S004R-0201	1/8	1/16
29-S004R-0401	1/4	1/16
29-S004R-0402	1/4	1/8
29-S004R-04M06	1/4	6mm
29-S004R-0504	5/16	1/4
29-S004R-0602	3/8	1/8
29-S004R-0604	3/8	1/4
29-S004R-0605	3/8	5/16
29-S004R-0804	1/2	1/4
29-S004R-0806	1/2	3/8
29-S004R-1005	5/8	5/16
29-S004R-1008	5/8	1/2
29-S004R-1206	3/4	3/8
29-S004R-1208	3/4	1/2
29-S004R-1608	1"	1/2
29-S004R-1612	1"	3/4
29-S304R-10I06	10mm	3/8
29-S304R-12I06	12mm	3/8



#5SS
Male
Elbow

Code	Tube	Male
29-S005-0202	1/8	1/8 BSPT
29-S005-0204	1/8	1/4 BSPT
29-S005-0302	3/16	1/8 BSPT
29-S005-0402	1/4	1/8 BSPT
29-S005-0404	1/4	1/4 BSPT
29-S005-0406	1/4	3/8 BSPT
29-S005-0408	1/4	1/2 BSPT
29-S005-0502	5/16	1/8 BSPT
29-S005-0504	5/16	1/4 BSPT
29-S005-0506	5/16	3/8 BSPT
29-S005-0508	5/16	1/2 BSPT
29-S005-0602	3/8	1/8 BSPT
29-S005-0604	3/8	1/4 BSPT
29-S005-0606	3/8	3/8 BSPT
29-S005-0608	3/8	1/2 BSPT
29-S005-0804	1/2	1/4 BSPT
29-S005-0806	1/2	3/8 BSPT
29-S005-0808	1/2	1/2 BSPT
29-S005-0812	1/2	3/4 BSPT
29-S005-1006	5/8	3/8 BSPT
29-S005-1008	5/8	1/2 BSPT
29-S005-1208	3/4	1/2 BSPT
29-S005-1212	3/4	3/4 BSPT
29-S005-1612	1"	3/4 BSPT
29-S005-1616	1"	1" BSPT
Continued next Column		



#5SS
Male
Elbow

Code	Tube	Male
From Previous Column		
29-S205-0202	1/8	1/8 NPT
29-S205-0204	1/8	1/4 NPT
29-S205-0302	3/16	1/8 NPT
29-S205-0304	3/16	1/4 NPT
29-S205-0402	1/4	1/8 NPT
29-S205-0404	1/4	1/4 NPT
29-S205-0406	1/4	3/8 NPT
29-S205-0408	1/4	1/2 NPT
29-S205-0502	5/16	1/8 NPT
29-S205-0504	5/16	1/4 NPT
29-S205-0506	5/16	3/8 NPT
29-S205-0602	3/8	1/8 NPT
29-S205-0604	3/8	1/4 NPT
29-S205-0606	3/8	3/8 NPT
29-S205-0608	3/8	1/2 NPT
29-S205-0612	3/8	3/4 NPT
29-S205-0804	1/2	1/4 NPT
29-S205-0806	1/2	3/8 NPT
29-S205-0808	1/2	1/2 NPT
29-S205-0812	1/2	3/4 NPT
29-S205-1004	5/8	1/4 NPT
29-S205-1006	5/8	3/8 NPT
29-S205-1008	5/8	1/2 NPT
29-S205-1208	3/4	1/2 NPT
29-S205-1212	3/4	3/4 NPT
29-S205-1612	1"	3/4 NPT
29-S205-1616	1"	1" NPT
29-S305-0602	6mm	1/8 BSPT
29-S305-0604	6mm	1/4 BSPT
29-S305-0608	6mm	1/2 BSPT
29-S305-1004	10mm	1/4 BSPT
29-S305-1006	10mm	3/8 BSPT
29-S305-1008	10mm	1/2 BSPT
29-S305-1204	12mm	1/4 BSPT
29-S305-1206	12mm	3/8 BSPT
29-S305-1208	12mm	1/2 BSPT



#5DSS
45° Male
Elbow

Code	Tube	Male
29-S005D-0606	3/8	3/8 BSPT

Stainless Steel Twin Ferrule Compression Fittings (Category 29)

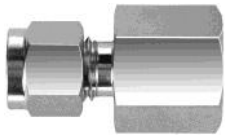

#10SS
Female
Connector

Code	Tube	Female
29-S010-0202	1/8	1/8 BSPT
29-S010-0302	3/16	1/8 BSPT
29-S010-0402	1/4	1/8 BSPT
29-S010-0404	1/4	1/4 BSPT
29-S010-0406	1/4	3/8 BSPT
29-S010-0408	1/4	1/2 BSPT
29-S010-0502	5/16	1/8 BSPT
29-S010-0504	5/16	1/4 BSPT
29-S010-0602	3/8	1/8 BSPT
29-S010-0604	3/8	1/4 BSPT
29-S010-0606	3/8	3/8 BSPT
29-S010-0608	3/8	1/2 BSPT
29-S010-0804	1/2	1/4 BSPT
29-S010-0806	1/2	3/8 BSPT
29-S010-0808	1/2	1/2 BSPT
29-S010-0812	1/2	3/4 BSPT
29-S010-1008	5/8	1/2 BSPT
29-S010-1208	3/4	1/2 BSPT
29-S010-1212	3/4	3/4 BSPT
29-S010-1616	1"	1" BSPT
29-S110-0408	1/4	1/2 BSPP
29-S110-0808	1/2	1/2 BSPP
29-S210-0202	1/8	1/8 NPT
29-S210-0204	1/8	1/4 NPT
29-S210-0302	3/16	1/8 NPT
29-S210-0402	1/4	1/8 NPT
29-S210-0404	1/4	1/4 NPT
29-S210-0406	1/4	3/8 NPT
29-S210-0408	1/4	1/2 NPT
29-S210-0502	5/16	1/8 NPT
29-S210-0504	5/16	1/4 NPT
29-S210-0602	3/8	1/8 NPT
29-S210-0604	3/8	1/4 NPT
29-S210-0606	3/8	3/8 NPT
29-S210-0608	3/8	1/2 NPT
29-S210-0804	1/2	1/4 NPT
29-S210-0806	1/2	3/8 NPT
29-S210-0808	1/2	1/2 NPT
29-S210-0812	1/2	3/4 NPT
29-S210-1006	5/8	3/8 NPT
29-S210-1008	5/8	1/2 NPT
29-S210-1208	3/4	1/2 NPT
29-S210-1212	3/4	3/4 NPT
29-S210-1612	1"	3/4 NPT
29-S210-1616	1"	1" NPT



#10FSS
JIC Female
Tube Adaptor

Code	Tube (F)	Female
29-S610F-0808	1/2	3/4 JIC



#11SS
Elbow Tube
Union

Code	Tube
29-S011-02	1/8
29-S011-03	3/16
29-S011-04	1/4
29-S011-05	5/16
29-S011-06	3/8
29-S011-08	1/2
29-S011-10	5/8
29-S011-12	3/4
29-S011-16	1"
29-S011-32	2"
29-S311-06	6mm
29-S311-10	10mm
29-S311-12	12mm
29-S311-15	15mm



#11BHSS
Elbow Bulkhead
Tube Union

Code	Tube
29-S011BH-04	1/4
29-S011BH-08	1/2
29-S011BH-12	3/4



#13FSS
Female Run
Tee

Code	Tube	Female
29-S013F-0402	1/4	1/8 BSPT
29-S013F-0404	1/4	1/4 BSPT
29-S013F-0604	3/8	1/4 BSPT
29-S013F-0802	1/2	1/8 BSPT
29-S013F-0806	1/2	3/8 BSPT
29-S013F-1212	3/4	3/4 BSPT
29-S213F-0402	1/4	1/8 NPT
29-S213F-0404	1/4	1/4 NPT
29-S213F-0604	3/8	1/4 NPT
29-S213F-0606	3/8	3/8 NPT
29-S213F-0806	1/2	3/8 NPT
29-S213F-0808	1/2	1/2 NPT
29-S213F-1212	3/4	3/4 NPT



#12SS
Male Branch
Tee

Code	Tube	Male
29-S012-0302	3/16	1/8 BSPT
29-S012-0402	1/4	1/8 BSPT
29-S012-0404	1/4	1/4 BSPT
29-S012-0504	5/16	1/4 BSPT
29-S012-0506	5/16	3/8 BSPT
29-S012-0604	3/8	1/4 BSPT
29-S012-0606	3/8	3/8 BSPT
29-S012-0804	1/2	1/4 BSPT
29-S012-0806	1/2	3/8 BSPT
29-S012-0808	1/2	1/2 BSPT
29-S012-1008	5/8	1/2 BSPT
29-S012-1208	3/4	1/2 BSPT
29-S212-0202	1/8	1/8 NPT
29-S212-0204	1/8	1/4 NPT
29-S212-0402	1/4	1/8 NPT
29-S212-0404	1/4	1/4 NPT
29-S212-0604	3/8	1/4 NPT
29-S212-0606	3/8	3/8 NPT
29-S212-0804	1/2	1/4 NPT
29-S212-0806	1/2	3/8 NPT
29-S212-0808	1/2	1/2 NPT
29-S212-1008	5/8	1/2 NPT
29-S212-1212	3/4	3/4 NPT



#12FSS
Female
Branch Tee

Code	Tube	Female
29-S012F-0202	1/8	1/8 BSPT
29-S012F-0402	1/4	1/8 BSPT
29-S012F-0404	1/4	1/4 BSPT
29-S012F-0604	3/8	1/4 BSPT
29-S012F-0606	3/8	3/8 BSPT
29-S012F-0804	1/2	1/4 BSPT
29-S012F-0806	1/2	3/8 BSPT
29-S012F-0808	1/2	1/2 BSPT
29-S012F-1002	5/8	1/8 BSPT
29-S012F-1616	1"	1" BSPT
29-S212F-0202	1/8	1/8 NPT
29-S212F-0404	1/4	1/4 NPT
29-S212F-0604	3/8	1/4 NPT
29-S212F-0606	3/8	3/8 NPT
29-S212F-0804	1/2	1/4 NPT
29-S212F-0806	1/2	3/8 NPT
29-S212F-0806	1/2	3/8 NPT
29-S212F-1212	3/4	3/4 NPT
29-S212F-1612	1"	3/4 NPT
29-S212F-1616	1"	1" NPT

Stainless Steel Twin Ferrule Compression Fittings (Category 29)



#13SS
Male Run Tee

Code	Tube	Male
29-S013-0402	1/4	1/8 BSPT
29-S013-0404	1/4	1/4 BSPT
29-S013-0506	5/16	3/8 BSPT
29-S013-0604	3/8	1/4 BSPT
29-S013-0606	3/8	3/8 BSPT
29-S013-0806	1/2	3/8 BSPT
29-S013-0808	1/2	1/2 BSPT
29-S213-0202	1/8	1/8 NPT
29-S213-0402	1/4	1/8 NPT
29-S213-0404	1/4	1/4 NPT
29-S213-0502	5/16	1/8 NPT
29-S213-0504	5/16	1/4 NPT
29-S213-0604	3/8	1/4 NPT
29-S213-0606	3/8	3/8 NPT
29-S213-0806	1/2	3/8 NPT
29-S213-0808	1/2	1/2 NPT
29-S213-1008	5/8	1/2 NPT
29-S213-1212	3/4	3/4 NPT
29-S313-1208	12mm	1/2 BSPT



#14SS
Tee Tube
Union

Code	Tube
29-S014-02	1/8
29-S014-03	3/16
29-S014-04	1/4
29-S014-05	5/16
29-S014-06	3/8
29-S014-08	1/2
29-S014-10	5/8
29-S014-12	3/4
29-S014-16	1"
29-S014-32	2"
29-S314-06	6mm
29-S314-10	10mm
29-S314-12	12mm



#31ASS
Bulkhead
Tube Adaptor

Code	Tube	Stem
29-S031A-04	1/4	1/4
29-S031A-08	1/2	1/2



#15SS
Female
Elbow

Code	Tube	Female
29-S015-0302	3/16	1/8 BSPT
29-S015-0402	1/4	1/8 BSPT
29-S015-0404	1/4	1/4 BSPT
29-S015-0406	1/4	3/8 BSPT
29-S015-0408	1/4	1/2 BSPT
29-S015-0502	5/16	1/8 BSPT
29-S015-0504	5/16	1/4 BSPT
29-S015-0604	3/8	1/4 BSPT
29-S015-0606	3/8	3/8 BSPT
29-S015-0806	1/2	3/8 BSPT
29-S015-0808	1/2	1/2 BSPT
29-S015-1208	3/4	1/2 BSPT
29-S015-1212	3/4	3/4 BSPT
29-S015-1616	1"	1" BSPT
29-S215-0202	1/8	1/8 NPT
29-S215-0302	3/16	1/8 NPT
29-S215-0402	1/4	1/8 NPT
29-S215-0404	1/4	1/4 NPT
29-S215-0408	1/4	1/2 NPT
29-S215-0504	5/16	1/4 NPT
29-S215-0602	3/8	1/8 NPT
29-S215-0604	3/8	1/4 NPT
29-S215-0606	3/8	3/8 NPT
29-S215-0608	3/8	1/2 NPT
29-S215-0804	1/2	1/4 NPT
29-S215-0806	1/2	3/8 NPT
29-S215-0808	1/2	1/2 NPT
29-S215-1006	5/8	3/8 NPT
29-S215-1212	3/4	3/4 NPT
29-S215-1612	1"	3/4 NPT
29-S215-1616	1"	1" NPT



#31SS
Bulkhead
Union

Code	Tube
29-S031-02	1/8
29-S031-04	1/4
29-S031-05	5/16
29-S031-06	3/8
29-S031-08	1/2
29-S031-10	5/8
29-S031-12	3/4



#31FSS
Female
Bulkhead

Code	Tube	Female
29-S031F-0402	1/4	1/8 BSPT
29-S031F-0404	1/4	1/4 BSPT
29-S031F-0604	3/8	1/4 BSPT
29-S031F-0808	1/2	1/2 BSPT
29-S231F-0402	1/4	1/8 NPT
29-S231F-0404	1/4	1/4 NPT
29-S231F-0604	3/8	1/4 NPT
29-S231F-0606	3/8	3/8 NPT
29-S231F-0806	1/2	3/8 NPT
29-S231F-0808	1/2	1/2 NPT



#31MSS
Male
Bulkhead

Code	Tube	Male
29-S031M-0402	1/4	1/8 BSPT
29-S031M-0404	1/4	1/4 BSPT
29-S031M-0604	3/8	1/4 BSPT
29-S031M-0606	3/8	3/8 BSPT
29-S031M-0806	1/2	3/8 BSPT
29-S031M-0808	1/2	1/2 BSPT
29-S231M-0402	1/4	1/8 NPT
29-S231M-0404	1/4	1/4 NPT
29-S231M-0604	3/8	1/4 NPT
29-S231M-0606	3/8	3/8 NPT
29-S231M-0806	1/2	3/8 NPT
29-S231M-0808	1/2	1/2 NPT

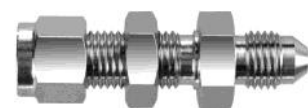

#31MSS
JIC Male
Bulkhead

Code	Tube	Male
29-S631M-0604	3/8	7/16 JIC
29-S631M-0606	3/8	9/16 JIC



#44SS
Port
Connector

Code	Tube
29-S044-02	1/8
29-S044-04	1/4
29-S044-06	3/8
29-S044-08	1/2
29-S044-16	1"

Stainless Steel Twin Ferrule Compression Fittings (Category 29)



**#56SS
Tube Plug**

Code	Tube
29-S056-01	1/16
29-S056-02	1/8
29-S056-03	3/16
29-S056-04	1/4
29-S056-05	5/16
29-S056-06	3/8
29-S056-08	1/2
29-S056-12	3/4
29-S056-16	1"



**#65SS
Tube Cap**

Code	Tube
29-S065-02	1/8
29-S065-03	3/16
29-S065-04	1/4
29-S065-05	5/16
29-S065-06	3/8
29-S065-08	1/2
29-S065-10	5/8
29-S065-12	3/4
29-S065-16	1"
29-S365-16	16mm



**#72ASS
Reducing Tube
Adaptor**

Code	Stem	Tube
29-S072A-0102	1/16	1/8
29-S072A-0201	1/8	1/16
29-S072A-0204	1/8	1/4
29-S072A-0304	3/16	1/4
29-S072A-0401	1/4	1/16
29-S072A-0402	1/4	1/8
29-S072A-0406	1/4	3/8
29-S072A-0408	1/4	1/2
29-S072A-0504	5/16	1/4
29-S072A-0604	3/8	1/4
29-S072A-0605	3/8	5/16
29-S072A-0608	3/8	1/2
29-S072A-0804	1/2	1/4
29-S072A-0805	1/2	5/16
29-S072A-0806	1/2	3/8
29-S072A-0812	1/2	3/4
29-S072A-1206	3/4	3/8
29-S072A-1208	3/4	1/2
29-S072A-1216	3/4	1"
29-S072A-1608	1"	1/2
29-S072A-1612	1"	3/4



**#44RSS
Reducing Port
Connector**

Code	Tube	Stem
29-S044R-0604	3/8	1/4
29-S044R-0804	1/2	1/4
29-S044R-0806	1/2	3/8



**#68SS
Union Cross**

Code	Tube
29-S068-02	1/8
29-S068-04	1/4
29-S068-05	5/16
29-S068-06	3/8
29-S068-08	1/2
29-S068-10	5/8
29-S068-12	3/4
29-S068-16	1"



**#72FSS
Female Tube
Adaptor**

Code	Stem	Female
29-S072F-0402	1/4	1/8 BSPT
29-S072F-0404	1/4	1/4 BSPT
29-S072F-0406	1/4	3/8 BSPT
29-S072F-0408	1/4	1/2 BSPT
29-S072F-0604	3/8	1/4 BSPT
29-S072F-0606	3/8	3/8 BSPT
29-S072F-0608	3/8	1/2 BSPT
29-S072F-0806	1/2	3/8 BSPT
29-S072F-0808	1/2	1/2 BSPT
29-S272F-0204	1/8	1/4 NPT
29-S272F-0402	1/4	1/8 NPT
29-S272F-0404	1/4	1/4 NPT
29-S272F-0406	1/4	3/8 NPT
29-S272F-0408	1/4	1/2 NPT
29-S272F-0504	5/16	1/4 NPT
29-S272F-0602	3/8	1/8 NPT
29-S272F-0604	3/8	1/4 NPT
29-S272F-0606	3/8	3/8 NPT
29-S272F-0608	3/8	1/2 NPT
29-S272F-0804	1/2	1/4 NPT
29-S272F-0806	1/2	3/8 NPT
29-S272F-0808	1/2	1/2 NPT
29-S272F-1208	3/4	1/2 NPT
29-S272F-1212	3/4	3/4 NPT
29-S272F-1216	3/4	1" NPT
29-S272F-1612	1"	3/4 NPT
29-S272F-1616	1"	1" NPT



**#72SS
Male Tube
Adaptor**

Code	Stem	Male
29-S072M-0402	1/4	1/8 BSPT
29-S072M-0404	1/4	1/4 BSPT
29-S072M-0406	1/4	3/8 BSPT
29-S072M-0408	1/4	1/2 BSPT
29-S072M-0504	5/16	1/4 BSPT
29-S072M-0602	3/8	1/8 BSPT
29-S072M-0604	3/8	1/4 BSPT
29-S072M-0606	3/8	3/8 BSPT
29-S072M-0608	3/8	1/2 BSPT
29-S072M-0804	1/2	1/4 BSPT
29-S072M-0806	1/2	3/8 BSPT
29-S072M-0808	1/2	1/2 BSPT
29-S072M-1208	3/4	1/2 BSPT
29-S072M-1212	3/4	3/4 BSPT
29-S072M-1612	1"	3/4 BSPT
29-S072M-1616	1"	1" BSPT
29-S272M-0202	1/8	1/8 NPT
29-S272M-0204	1/8	1/4 NPT
29-S272M-0402	1/4	1/8 NPT
29-S272M-0404	1/4	1/4 NPT
29-S272M-0406	1/4	3/8 NPT
29-S272M-0408	1/4	1/2 NPT
29-S272M-0602	3/8	1/8 NPT
29-S272M-0604	3/8	1/4 NPT
29-S272M-0606	3/8	3/8 NPT
29-S272M-0608	3/8	1/2 NPT
29-S272M-0806	1/2	3/8 NPT
29-S272M-0808	1/2	1/2 NPT
29-S272M-0812	1/2	3/4 NPT
29-S272M-1208	3/4	1/2 NPT
29-S272M-1212	3/4	3/4 NPT
29-S272M-1216	3/4	1" NPT
29-S272M-1612	1"	3/4 NPT
29-S272M-1616	1"	1" NPT
29-S272M-2020	1.1/4	1.1/4 NPT

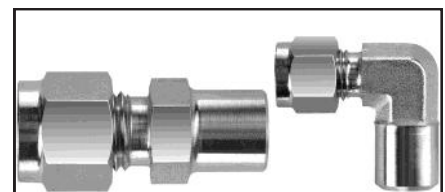

Some sizes of Socket Weld and Pipe Weld fittings also available in straight and elbows. Please contact the sales office for further information